

Shower faucet body.

In-built limitation options for water temperature and maximum flow-rate.

- Shower
- Seinapealne paigaldus
- Satiin
- Tagasilöögiklapid



Tehnilised andmed

Vooluhulk

Vooluhulk 300 kPa	0.27 l/s
Rõhukadu vooluhulgal (0.2 l/s)	155 kPa

Tehnilised omadused

Kuum vesi	max. +80°C
Kasutusurve	50 - 1000 kPa

Määrused

Hääleklass	II (ISO 3822)
------------	---------------

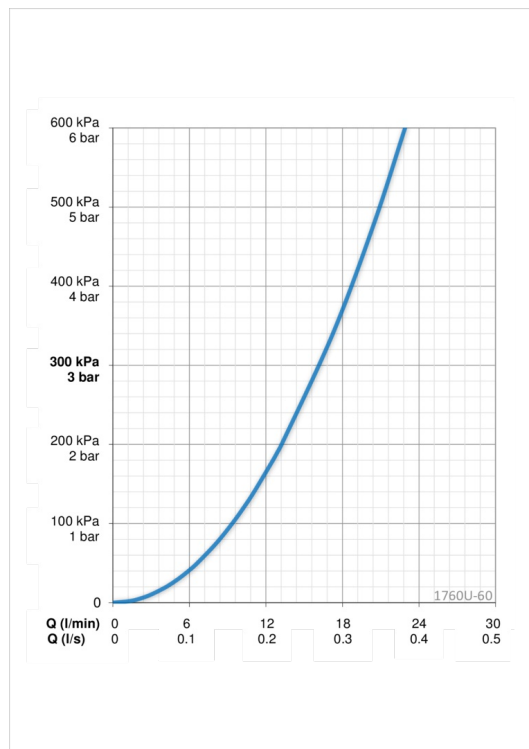

Varuosad

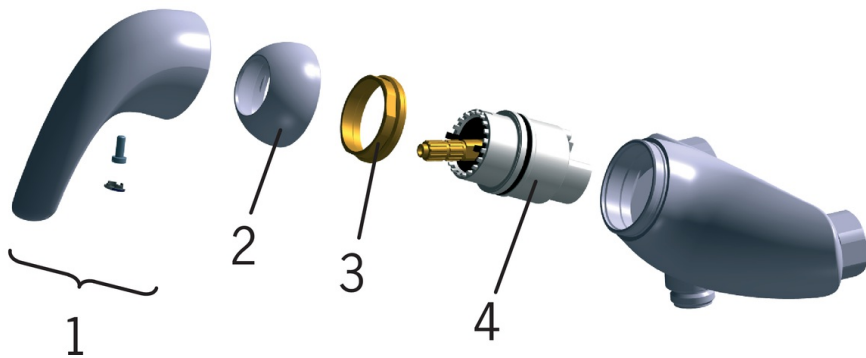

SP0105

	Nimetus	Kood
01	Kahv Satiin	159012V-60
01	Kahv	159012V
02	Kaitsekate	159013V
03	Pingutusmutter	158726
04	Seadeosa	158890